

# CAM® Quick Reference Instructions

 Review complete Instructions For Use online at [www.bardydx.com/CAMinstructions](http://www.bardydx.com/CAMinstructions) before using this product.

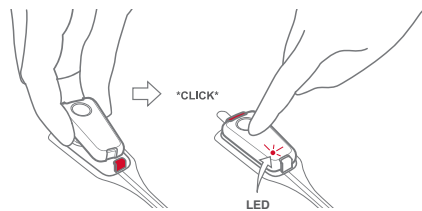

## 2 CAM PREP



**NOTE:** The activated 10 second LED blinking will only occur when the Recorder is connected to the Battrode. No additional blinking should occur while the CAM is being worn. Contact Customer Service if the LED does not blink as described.

### CONNECT

On a flat, hard surface insert the narrow end of the Recorder into the Battrode first with the event button facing up, and then push the Recorder down firmly. A green LED light will blink for 10 seconds to confirm activation. After the LED activation is confirmed, press down on the event button once to ensure the recorder is clicked firmly in place.

### DOCUMENT

Record the time of CAM activation, which will be required to complete patient registration.

CAM Prep

Two

## 1 SKIN PREP

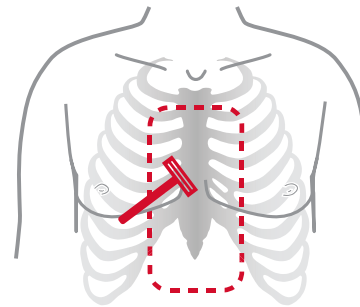

prep pads



### SHAVE

Remove all hair over sternal area by shaving close to the skin. Do not merely clip hair. The prepared area should extend 2 inches past where the Carnation Ambulatory Monitor (CAM) will be placed.

### CLEAN

Use all prep pads provided in the box to clean area shown. SCRUB the skin with the prep pads until they appear clean after use. Skin should be scrubbed well enough to be slightly reddened. Allow the skin to dry for 2 minutes prior to applying.

Skin Prep

One

## 3 APPLY

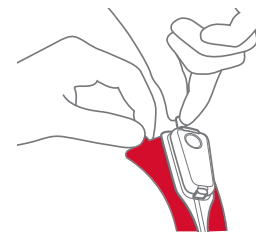

### PEEL

Gently peel the liner from the CAM by grasping the tab at the top of the device and peeling downward, carefully avoiding contact with the adhesive.

### LOCATE XIPHOID PROCESS

Locate the bone at the bottom of the sternum. This is the xiphoid process.

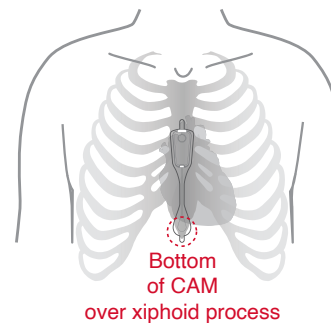

Apply the CAM to the patient's sternum with the bottom part sitting over the xiphoid process. Press along the entire edge of the patch for 2 minutes and rub firmly around the edges of the patch for 1 minute to ensure adhesion. Place two fingers below the event button and press down firmly to adhere the top of the CAM to the patient's chest.

Apply

Three

